

screen  
excellence

**ABSOLUTE**

**ASSEMBLING INSTRUCTIONS**

# COMPONENT LIST

## Mainframe:

1. Left half sub-assembly – Quantity 1
2. Right half sub-assembly - Quantity 1

## Accessories:

3. Joining L-profiles – Quantity 2 (*each with 4 M8 bolts and washers*) - **box**
4. M6 x 16 bolts with washers – Quantity 6 (*2 are attached to each joining profile and 4 more to prolongators*) - **box**
5. Joining U-profiles – Quantity 2 (*each with 4 M6 bolts and washers*) - **box**
6. Hex key – Quantity 2 (*Size 4 and 5*) - **box**

## Flanges:

7. Top flanges – Quantity 4 (velvet-covered)
8. Bottom flanges – Quantity 4 (velvet-covered)
9. Left and right flanges – Quantity 2 (velvet-covered – installed on screen)

## Accessories:

10. M4 x 5 screws - **box**

## Fabric:

11. White projection fabric – supplied in cardboard tube
12. Black backing fabric – supplied folded

## Accessories:

13. Spatula – Quantity 1 - **box**
14. Metal spatula (special shape) – Quantity 1 - **box**
15. Gloves – pair - **box**
16. Dust sheet - **box**

## Assembly advice

Ensure that there is a minimum of two people available – One person cannot handle the entire assembly alone.

Clear a space that is at least 1.5 times larger than the external dimensions of the screen with access to all sides – ideally, this should be a soft surface to protect the screen from damage.

Lay the two crates flat on the floor and carefully remove the lids. The lids are screwed in place.

Carefully remove all the components from the crates and check them against the components list.

Locate the plastic sheet (packed with the plastic spatula) and spread it out onto your soft assembly surface.

Several components (Flanges) are colour-coded with round coloured stickers.

**PLEASE RESPECT THE COLOUR CODING.** Your screen has been pre-assembled and tested in the factory, and the colour coding is important. If any stickers are missing or unclear, please refer to the handwritten numbers on the components. Identifying the correct components this way will avoid assembly errors and ensure proper installation.

The screen should be installed in a prepared recess. The recess should have at least 2cm extra space in width, height, and depth to ensure the screen fits. There are four brackets on the bottom platforms and two on top. Bottom brackets help keep the screen vertically, and the top brackets are used to prevent it from falling.

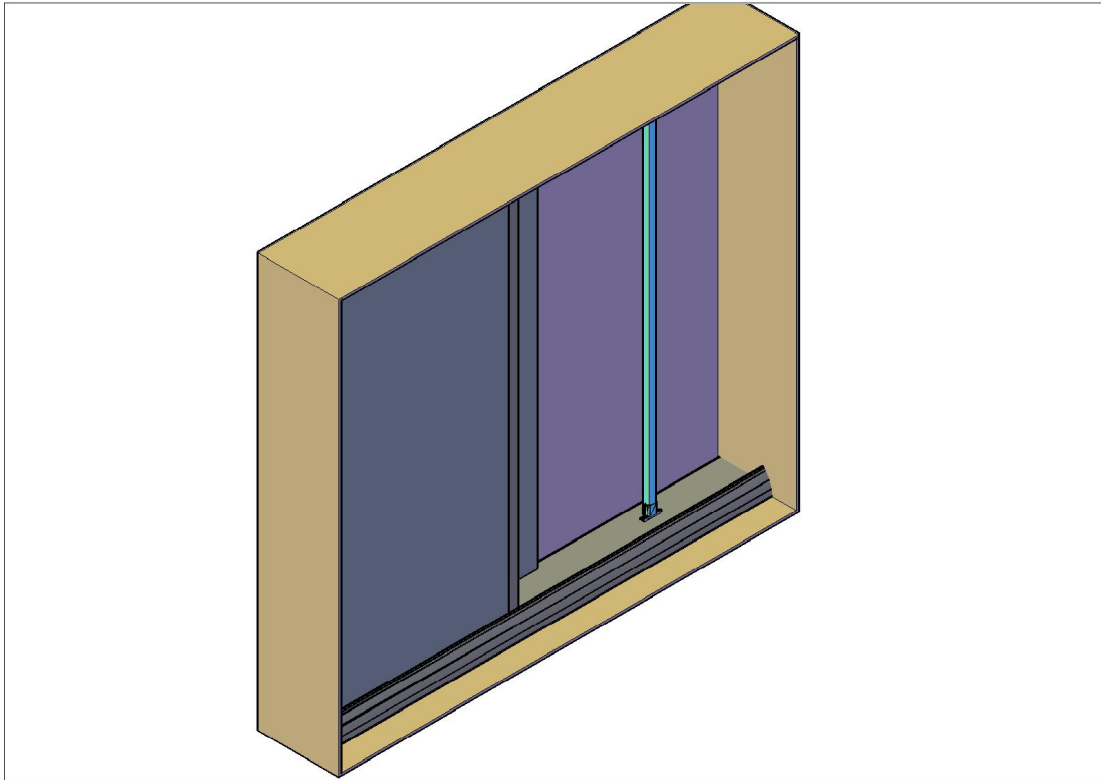

Place the protective sheet on a wide, clean surface sensibly larger than the complete screen. Place the 2 parts on the protective sheet.

Join the two halves of the screen. Tighten middle connectors with M6 bolts.

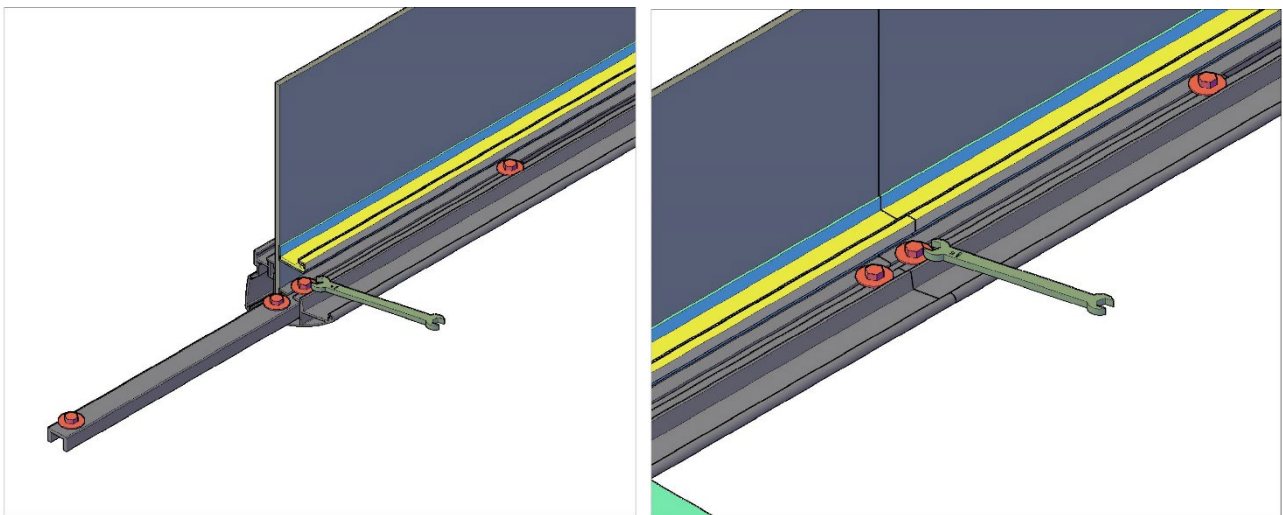

Place the provided U and L joining profiles in the middle of the screen. Use M6 and M8 screws to tighten them.

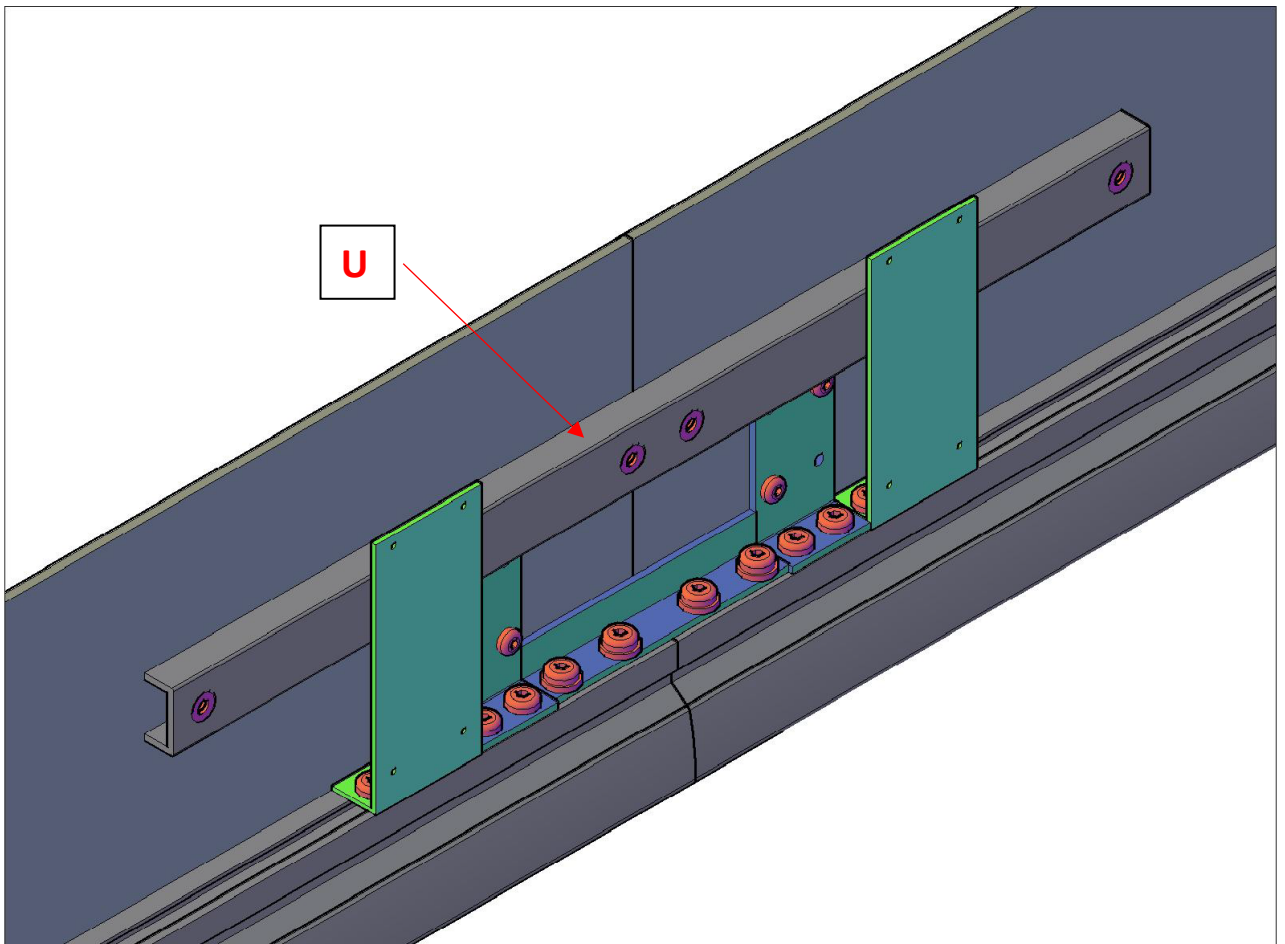
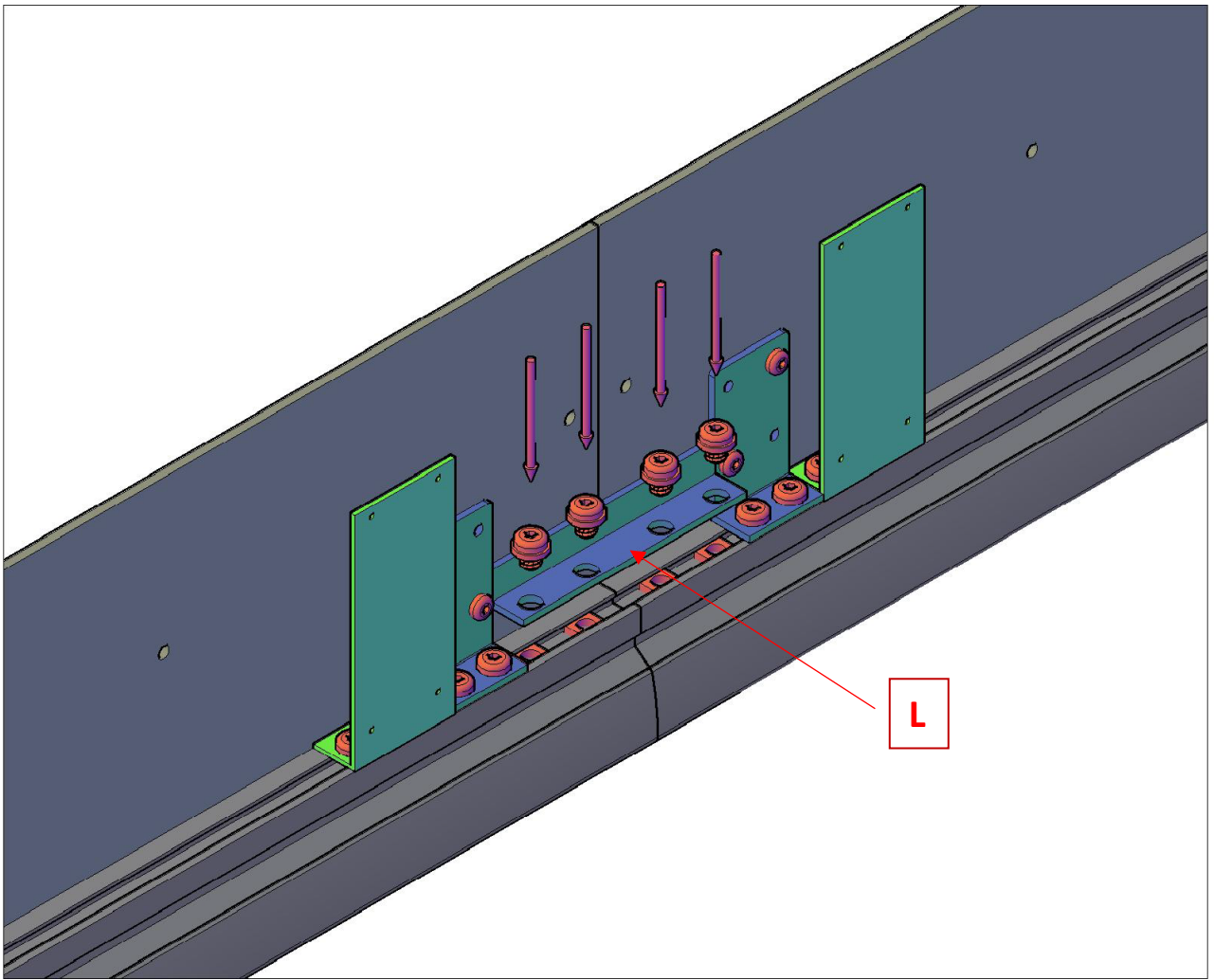

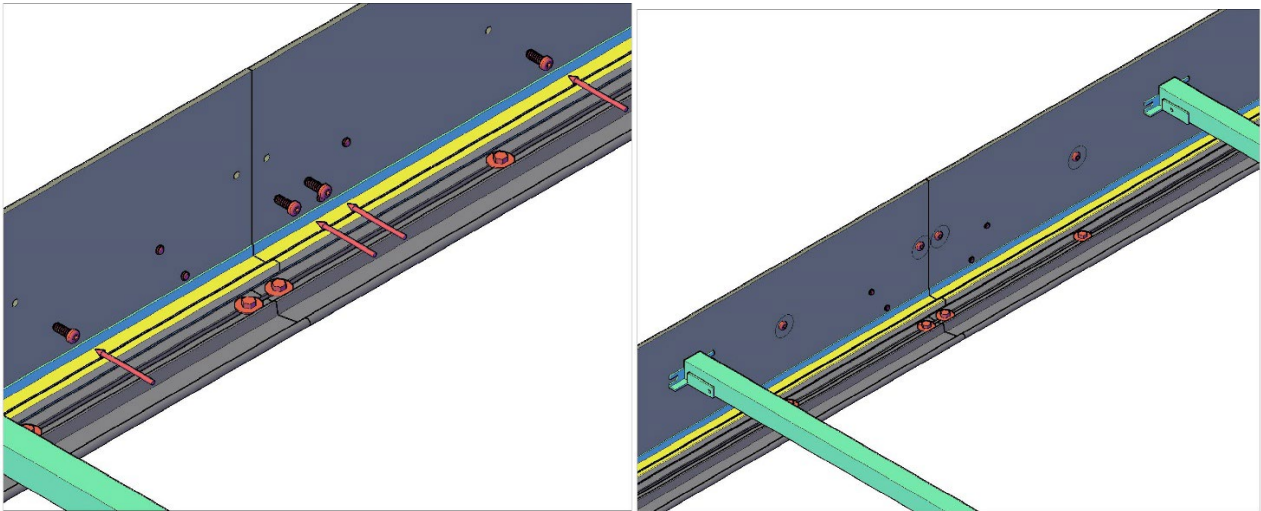

**The screen is delivered with halfway open masks. Before fixing fabrics, masks need to be fully "open".**

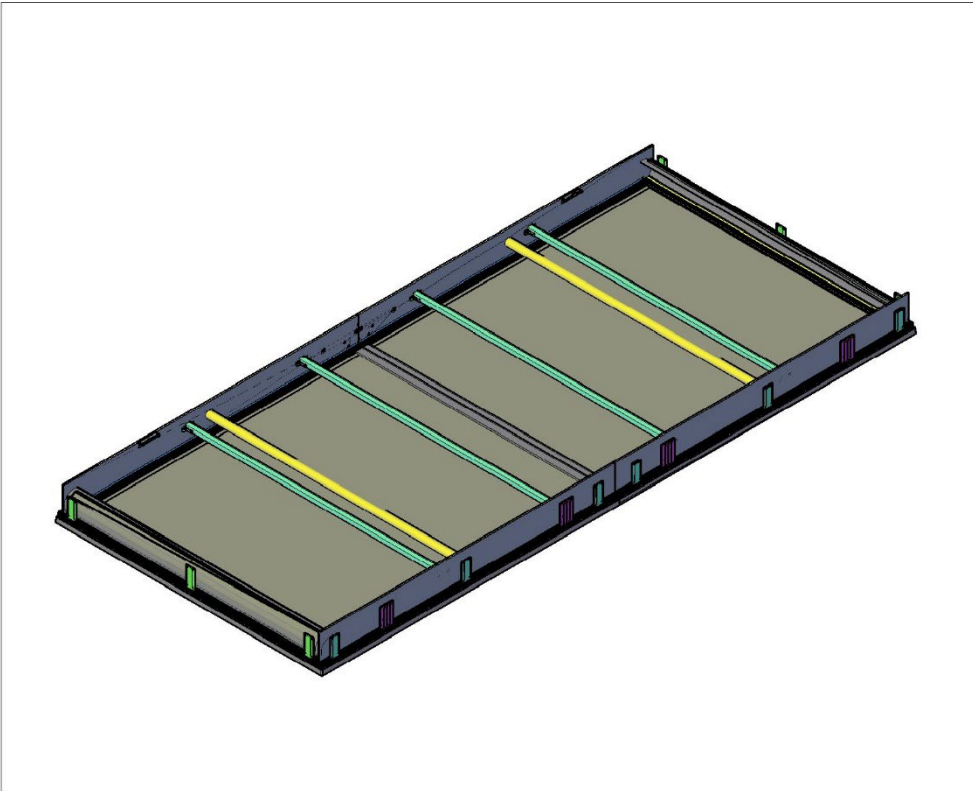
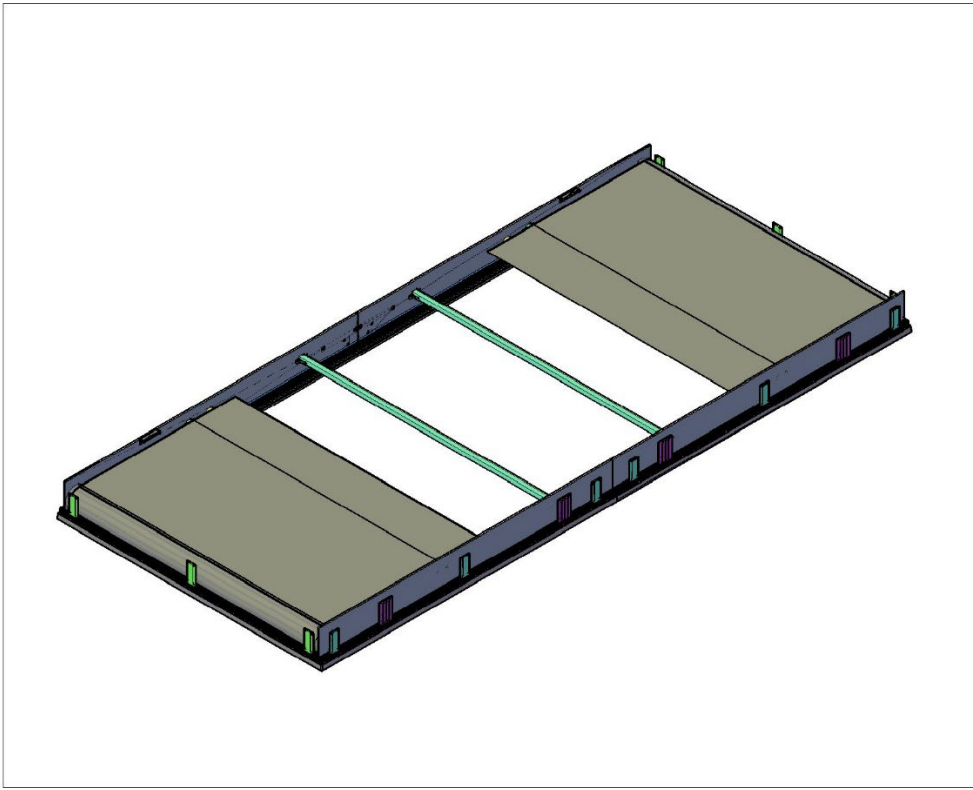

Place the white fabric on the screen.

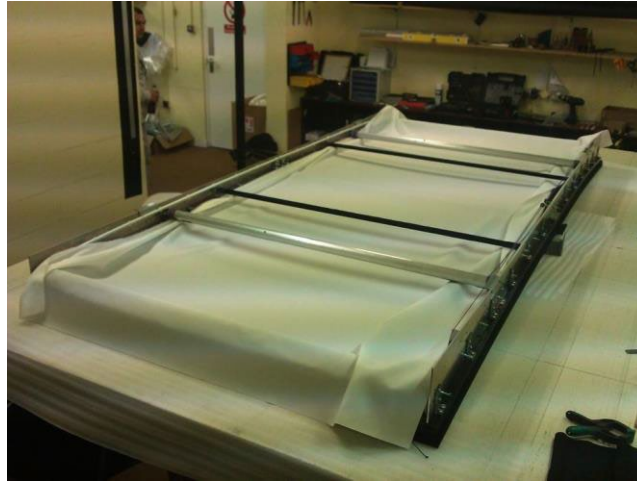

**Beware of not standing on the white fabric.**

Insert the fabric into the groove of the Gripfix profile with the provided spatula. Start with the middle of the four sides (the large sides first) and then progress towards the corners. Use a special shape spatula to insert fabric under motor tubes and stiffening bars (vertical support bars, velvet-covered)

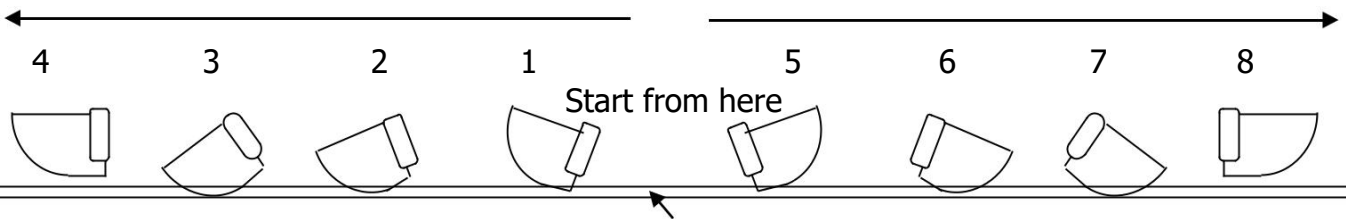
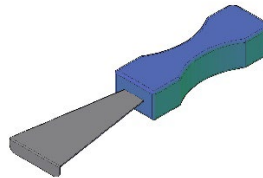

It is safer to perceive the insertion angle by simply inserting the tool once in the profile without the fabric. Then remove it, place the fabric over the profile and insert it inside.

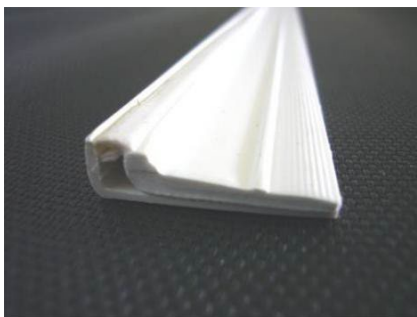

Gripfix profile

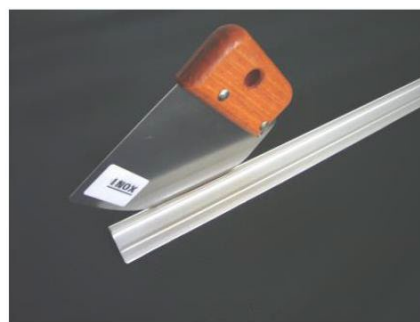

Gripfix profile & inserted spatula

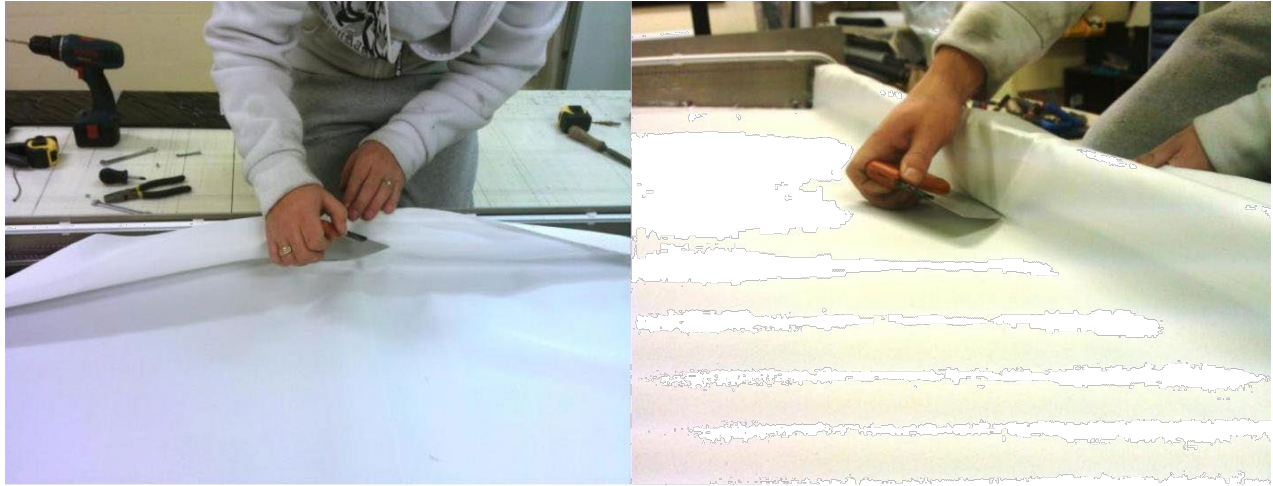

Note:

Before inserting the fabric in the profile groove, apply a very slight tension. The progressive insertion into the groove will significantly increase this tension. Once you have reached the end of the curved edge, take the tool out of the profile, and start again.

Check that the tension is sufficiently uniform to avoid uneven bending of the screen frame. It must be sufficient to avoid any wave or wrinkle.

Once the white fabric is stretched, check the evenness of the surface. The tension is not to be excessive. In case of a problem, release locally the fabric from the profile, and insert it again. Cut off the excess fabric to 10 mm.

Place the Black Backing fabric on the screen and repeat insert process.

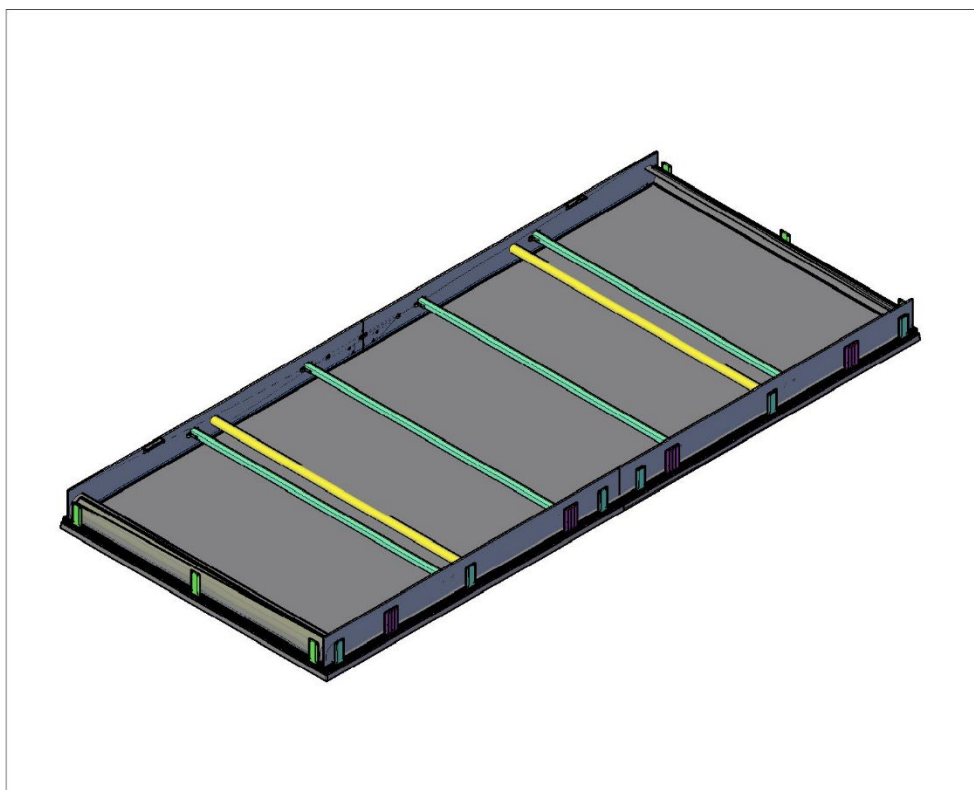

Use an Allen key/screwdriver and M4 black screws to mount flanges (follow colour

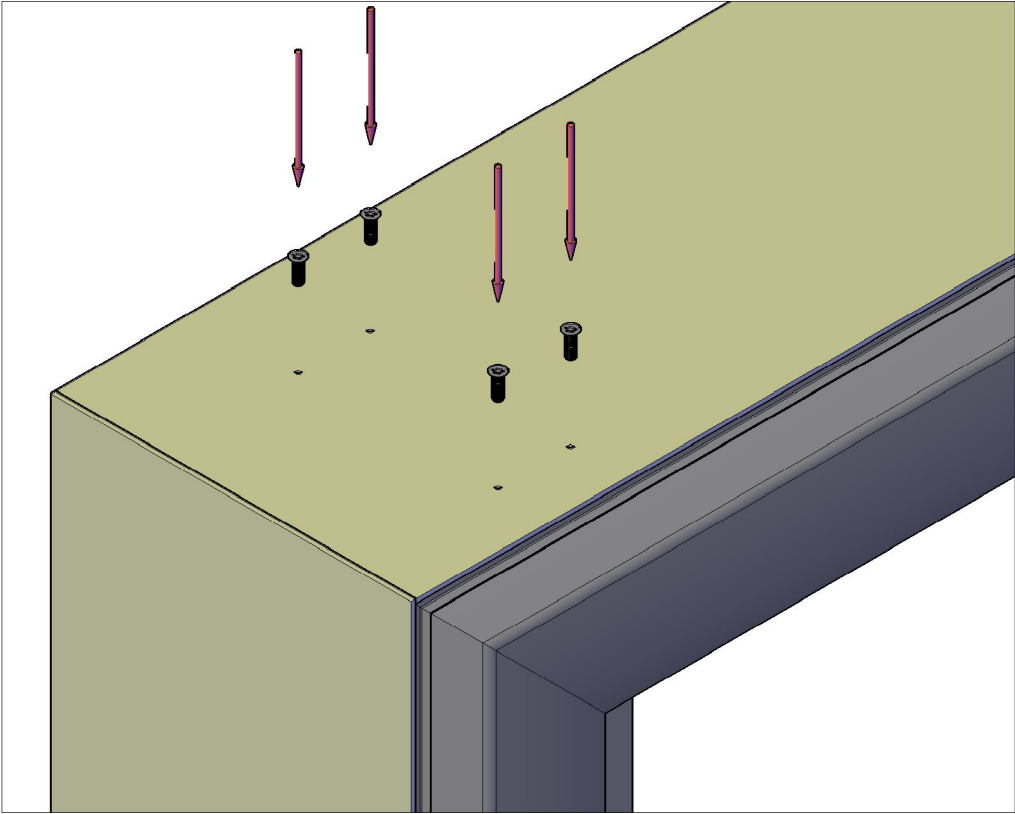

code).

It is recommended that the screen be placed on a stand.

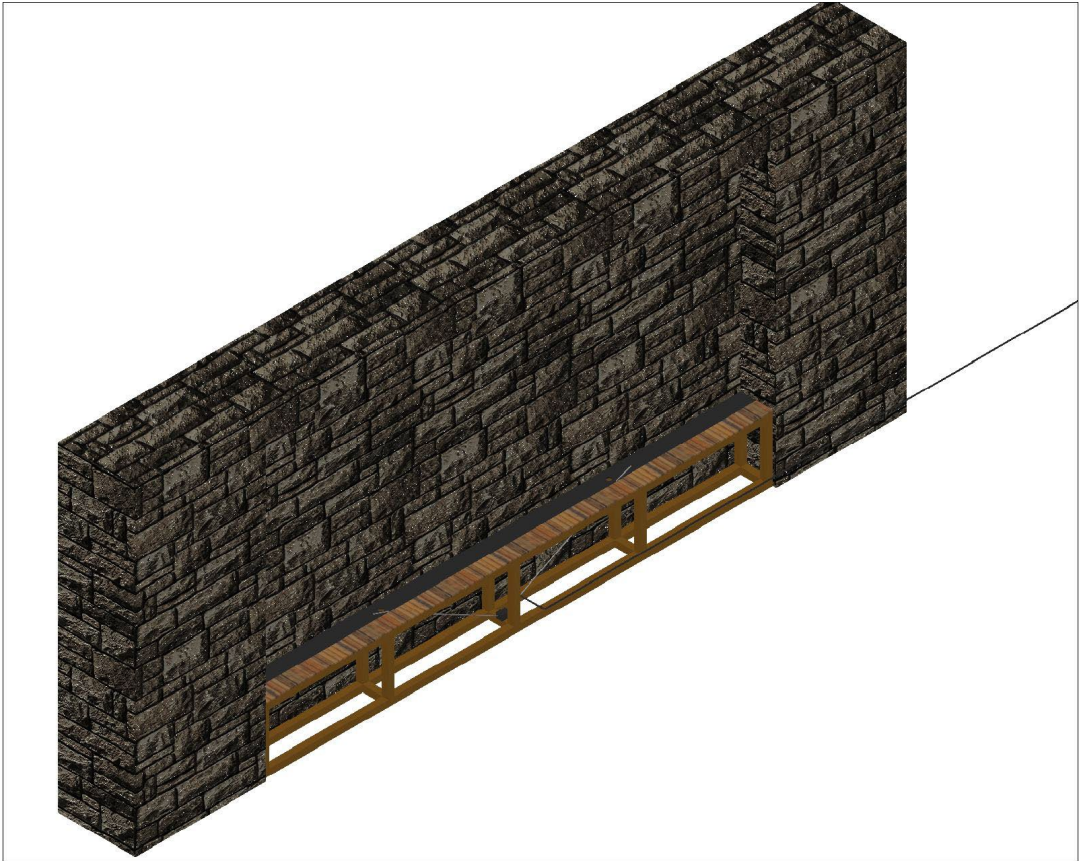

Lift screen and install on right position.

