

screen  
excellence

**TAM FC**

**ASSEMBLING INSTRUCTIONS**

# COMPONENT LIST

## Main frame:

1. Left half sub-assembly – Quantity 1
2. Right half sub-assembly - Quantity 1

## Accessories:

3. Joining L-profiles – Quantity 2 (*each with 4 M8 bolts and washers*) - **box**
4. M6 x 16 bolts with washers – Quantity 6 (*2 are attached to each joining profile and 4 more to prolongators*) - **box**
5. Joining U-profiles – Quantity 2 (*each with 4 M6 bolts and washers*) - **box**
6. Hex key – Quantity 2 (*Size 4 and 5*) - **box**

## Flanges:

7. Top flanges – Quantity 4 (velvet covered)
8. Bottom flanges – Quantity 4 (velvet covered)
9. Left and right flanges – Quantity 2 (velvet covered – installed on screen)

## Accessories:

10. M4 x 5 screws - **box**

## Fabric:

11. White projection fabric – supplied in cardboard tube
12. Black backing fabric – supplied folded

## Accessories:

13. Spatula – Quantity 1 - **box**
14. Metal spatula (special shape) – Quantity 1 - **box**
15. Gloves – pair - **box**
16. Dust sheet - **box**

## Assembly advice

Ensure that there are two/four people available – One person cannot handle the entire assembly alone.

Clear a space sufficiently larger than the external dimensions of the screen with access to all sides – ideally this should be a soft surface to protect the screen from damage.

Lay the two crates flat on the floor and carefully remove the lids. The lids are screwed in place.

Carefully remove all the components from the crates and check them against the components list.

Locate the plastic sheet (packed with the plastic spatula) and spread it out onto your soft assembly surface.

Several components (Flanges) are colour coded with round coloured stickers. **PLEASE RESPECT THE COLOUR CODING.** Your screen has been pre-assembled and tested in the factory and the colour coding is important.

Screen should be install in prepared recess. There are four brackets on bottom platforms and two on top. Bottom brackets help keep screen vertically when top brackets are to prevent from falling.

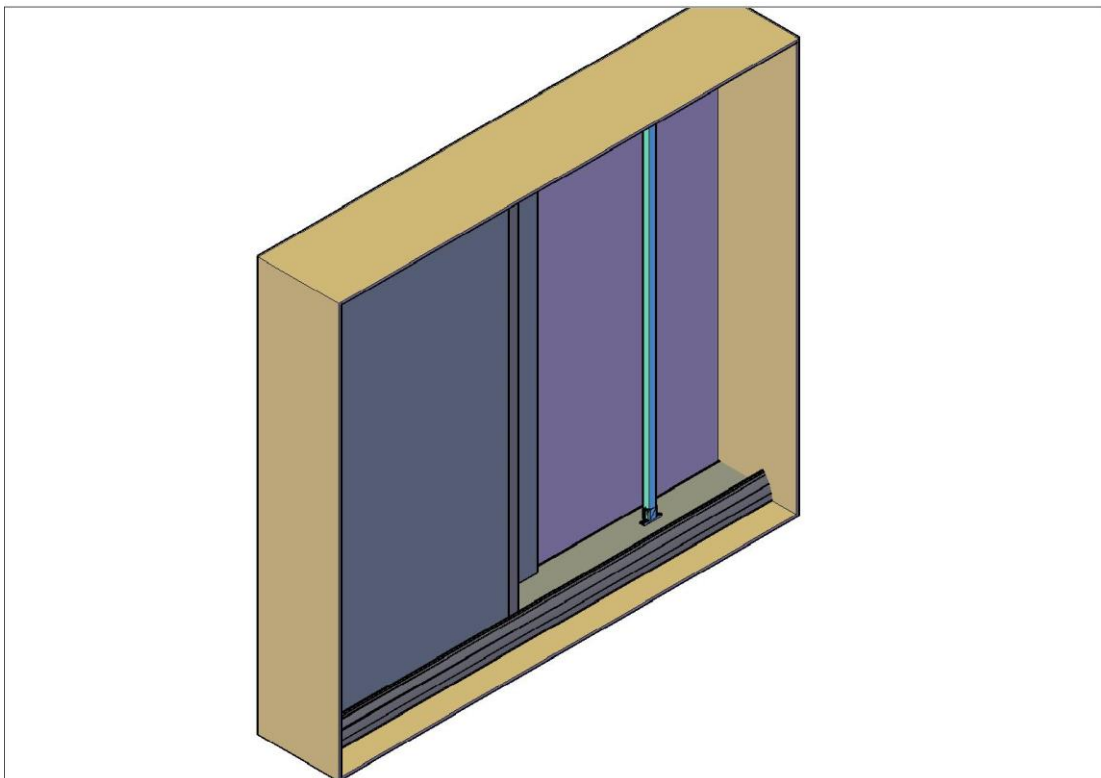

Place the protective sheet on a wide, clean surface sensibly larger than the complete screen. Place the 2 parts on the protective sheet.

Join two halves of screen. Tighten middle connectors with M6 bolts.

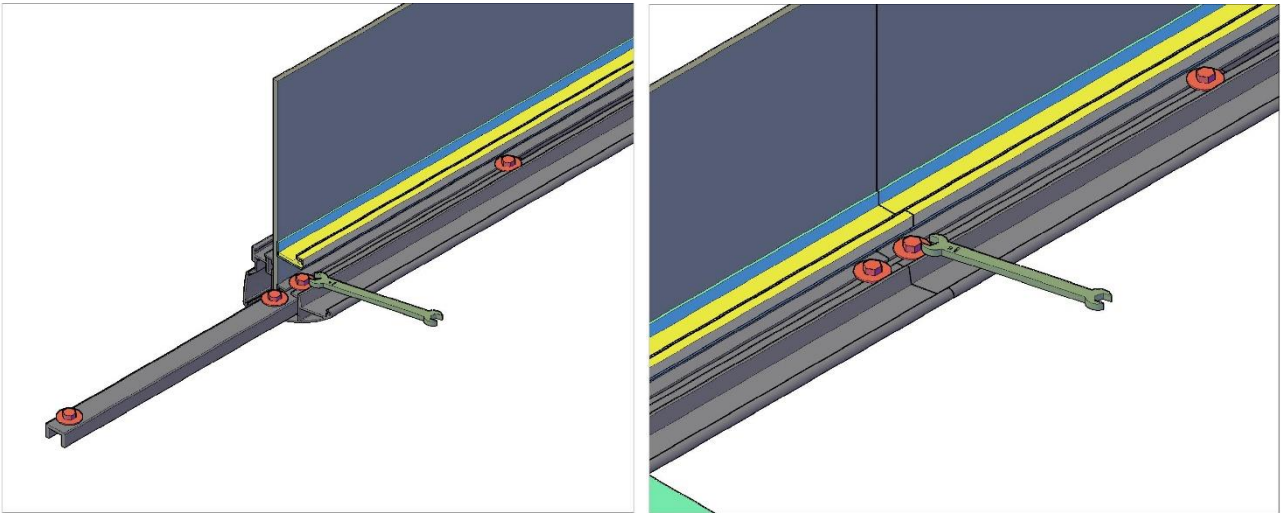

Place provided U and L joining profiles on the middle of screen. Use M6 and M8 screws to tighten them.

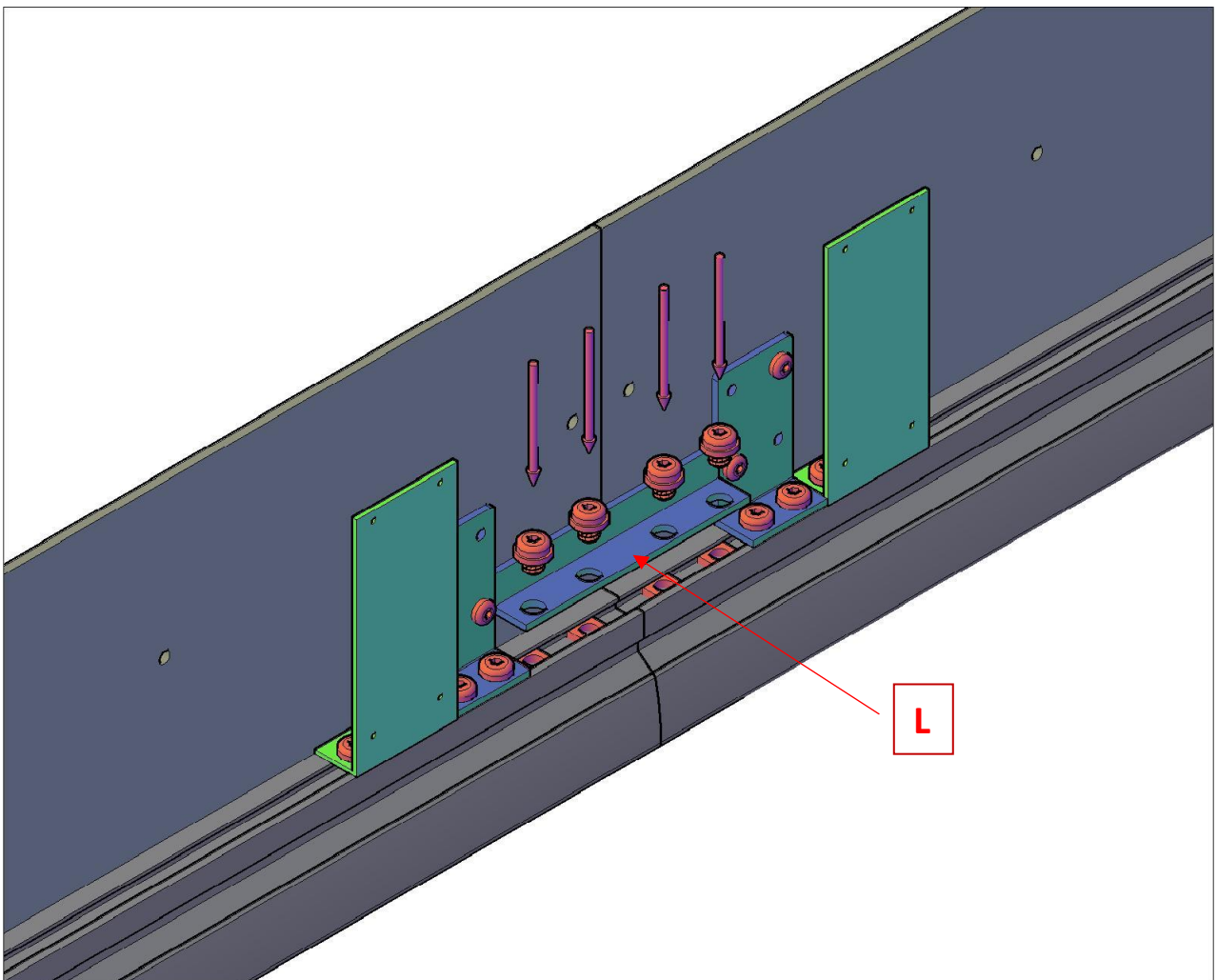

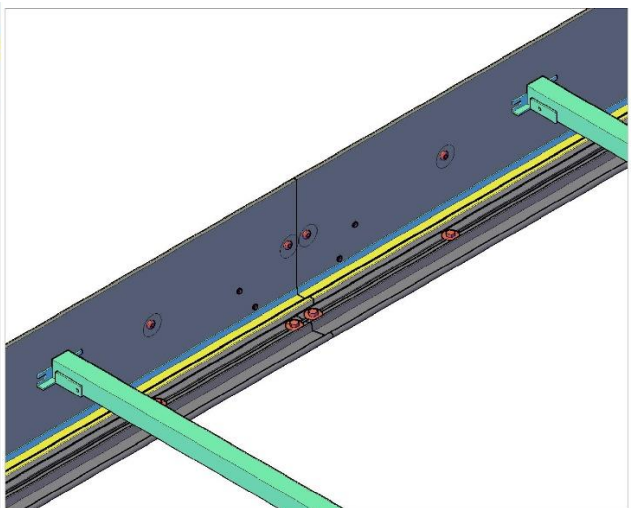
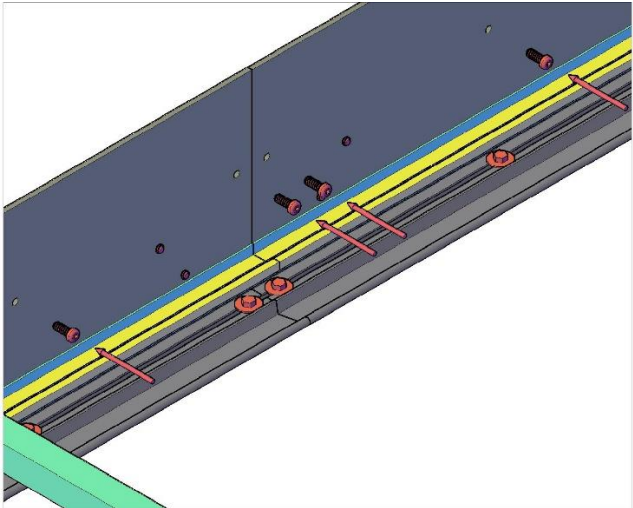
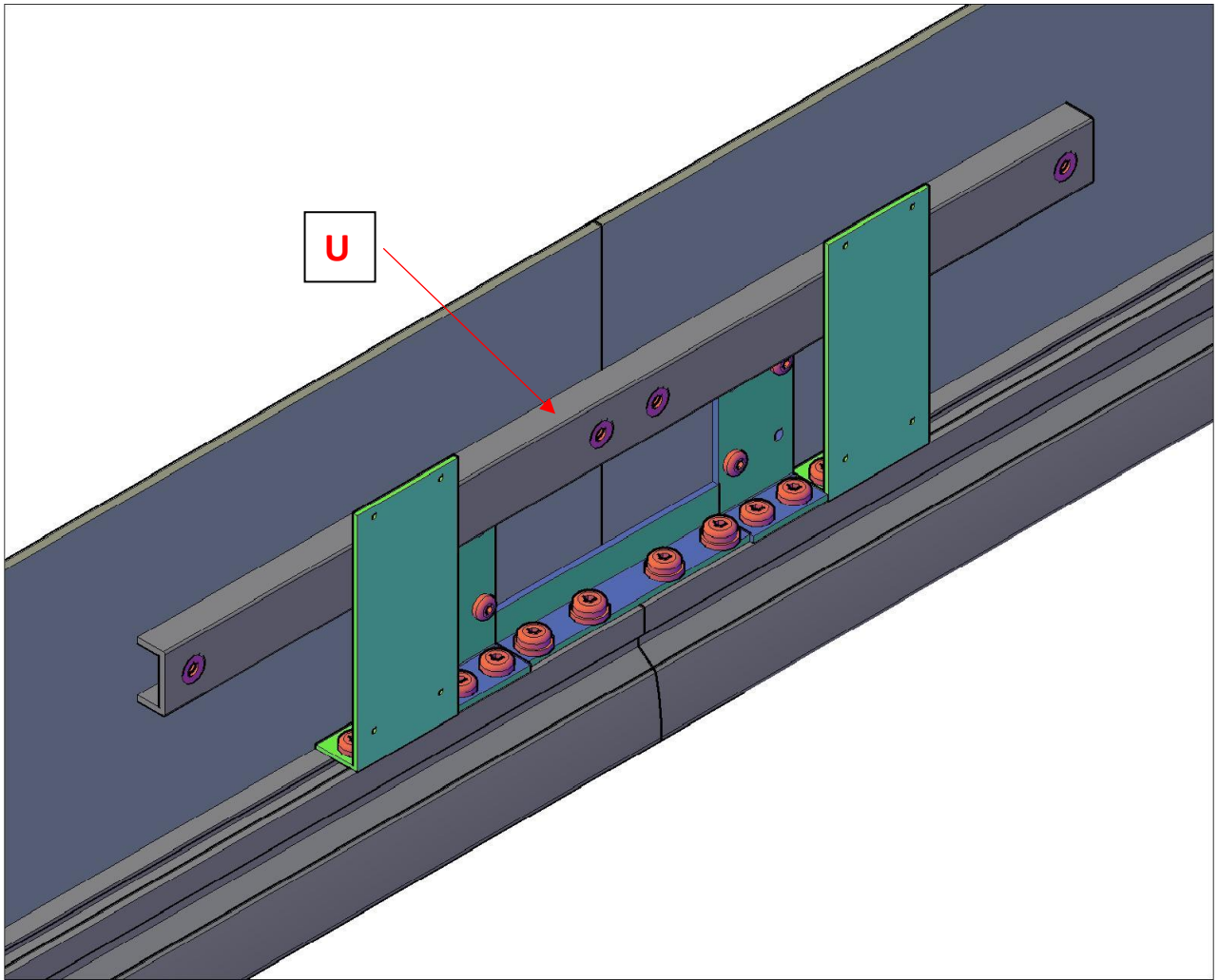

**Screen is delivered with half way open masks. Before fixing fabrics, masks need to be full "open".**

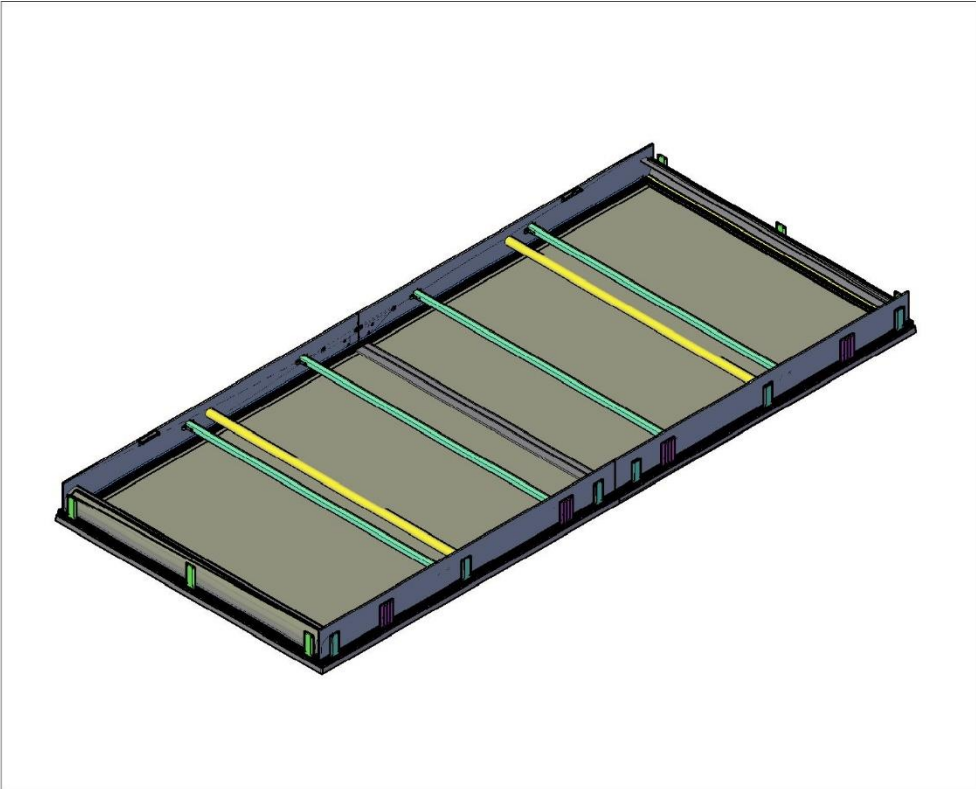
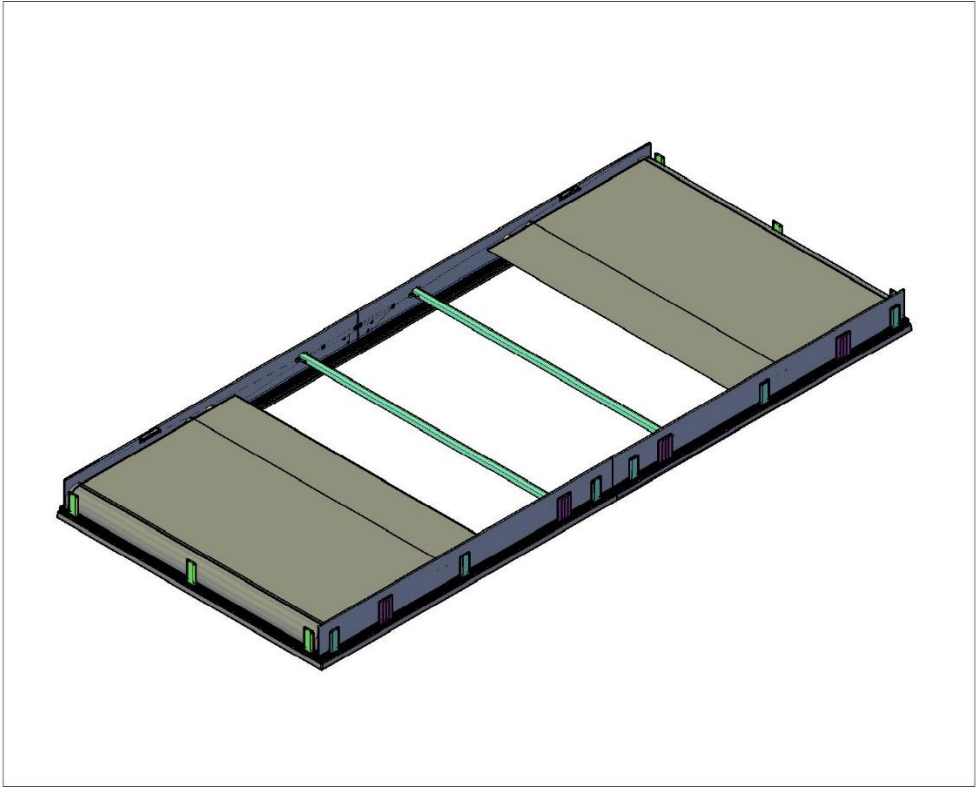

Place the white fabric on the screen.

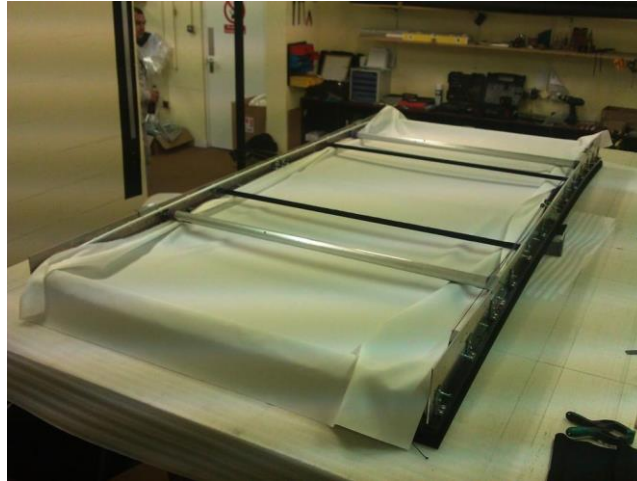

**Beware not to stand on the white fabric.**

Insert the fabric into the groove of the Gripfix profile with the provided spatula. Start by the middle of the four sides (the large sides first), and then progress towards the corners. Use special shape spatula to insert fabric under motor tubes and stiffening bars (vertical support bars velvet covered)

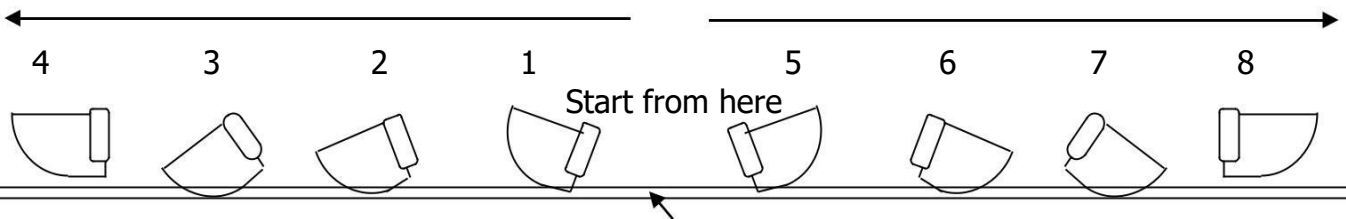
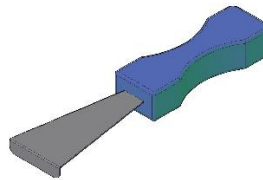

It is safer to perceive the insertion angle by simply inserting the tool once in the profile without the fabric. Then remove it, place the fabric over the profile and insert it inside.

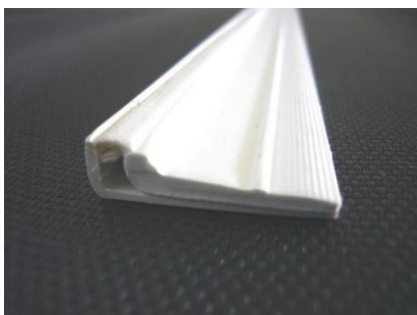

Gripfix profile (in black colour)



Gripfix profile & inserted spatula

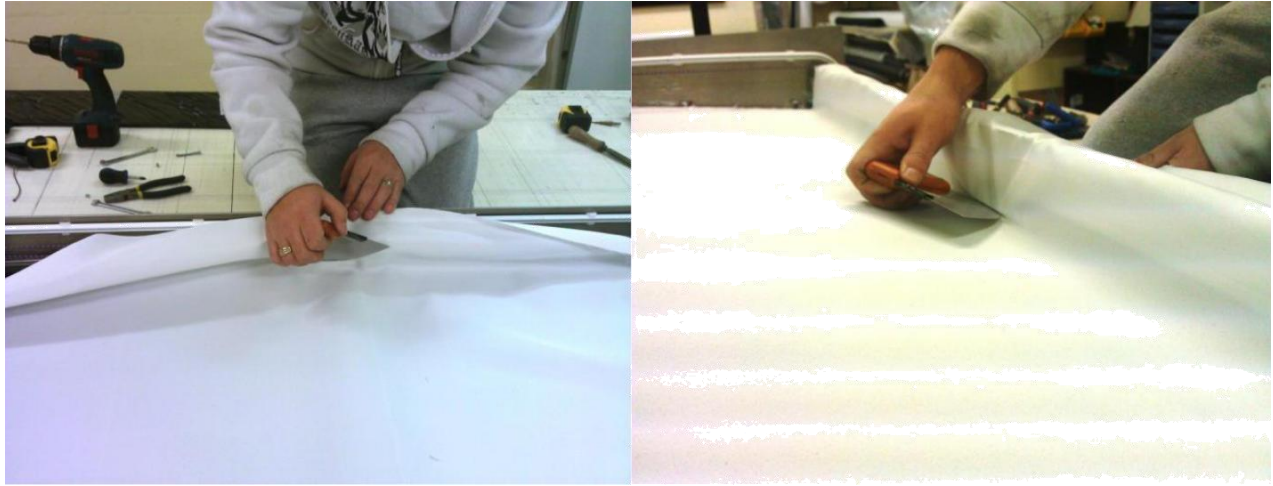

Note:

Before inserting the fabric in the profile groove, apply a very slight tension. The progressive insertion into the groove will significantly increase this tension. Once you have reached the end of the curved edge, take the tool out of the profile, and start again.

Check that the tension is sufficiently uniform to avoid uneven bending of the screen frame. It must be sufficient to avoid any wave or wrinkle.

Once the white fabric is stretched, check the evenness of the surface. The tension is not to be excessive. In case of a problem, release locally the fabric from the profile, and insert it again.

Place the Black Backing fabric on the screen and repeat insert process.

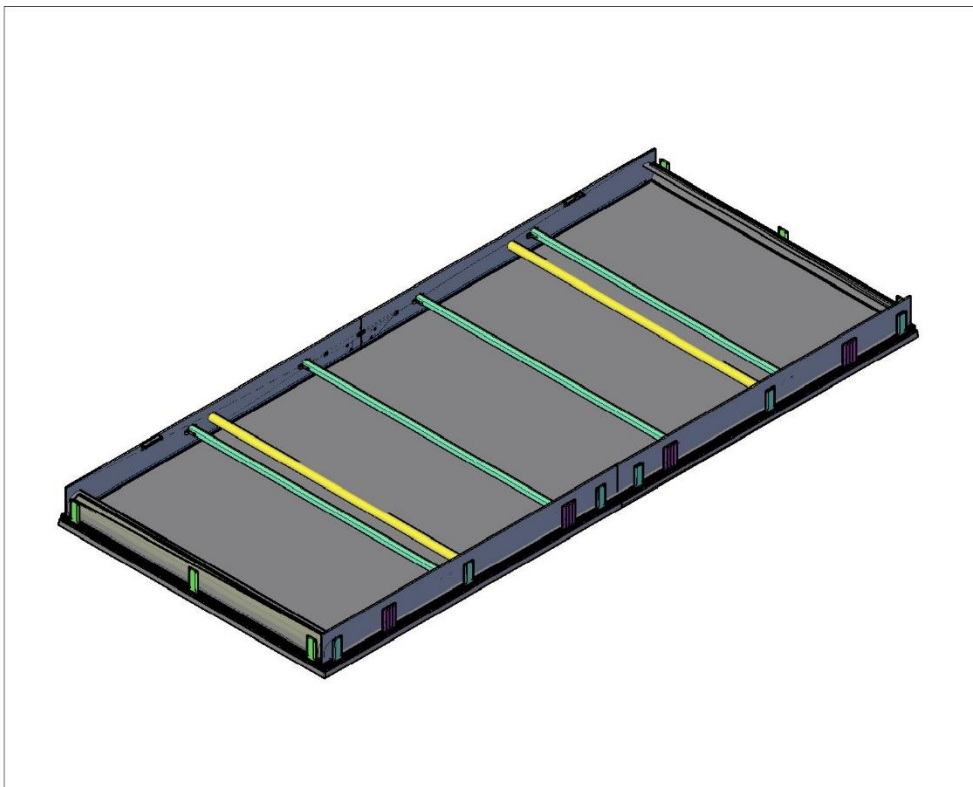

Use Allen key/screwdriver and M4 black screws to mount flanges (follow colour code).

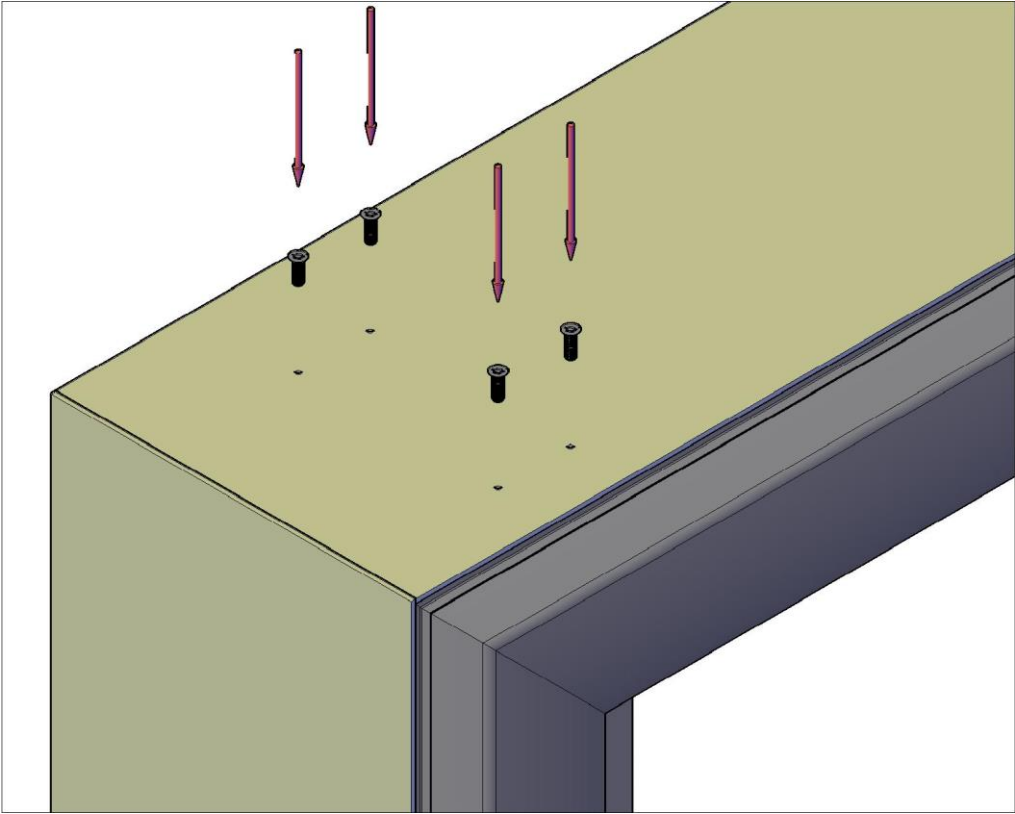

Is recommended that screen is place on stand.



Lift screen and install on right position.

